

INSTALLATION AND SERVICE MANUAL

For Installation of Funen 4 Underwater lighting LED.
Model. UFUN-50033

Product drawing (dimensions)

CE IP68 IK07 CLASS III 0.3m

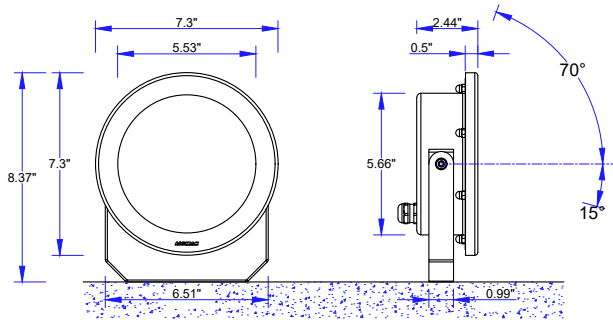

UFUN-50033

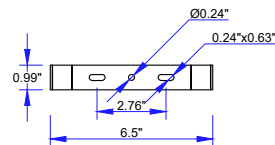

MOUNTING DETAIL

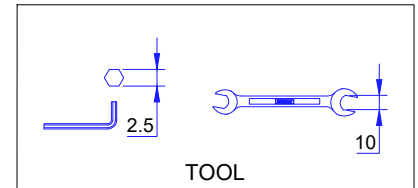

TOOL

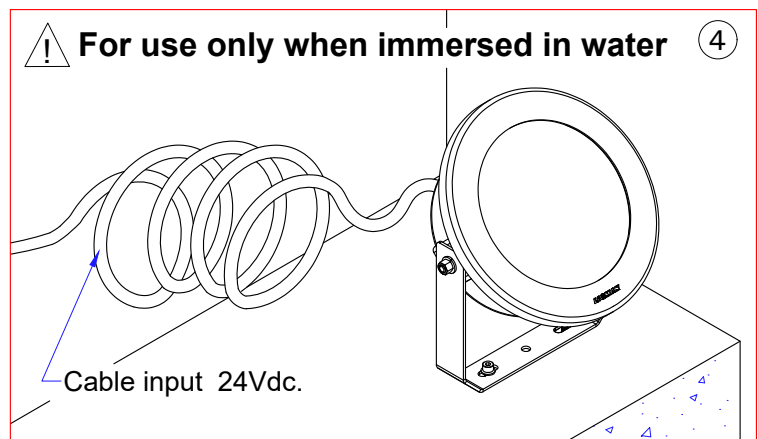
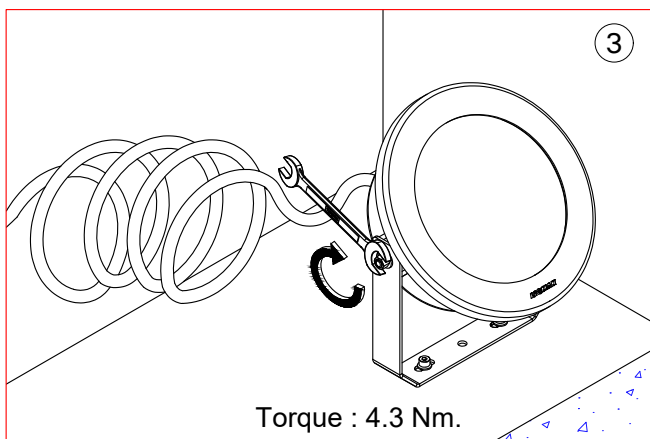
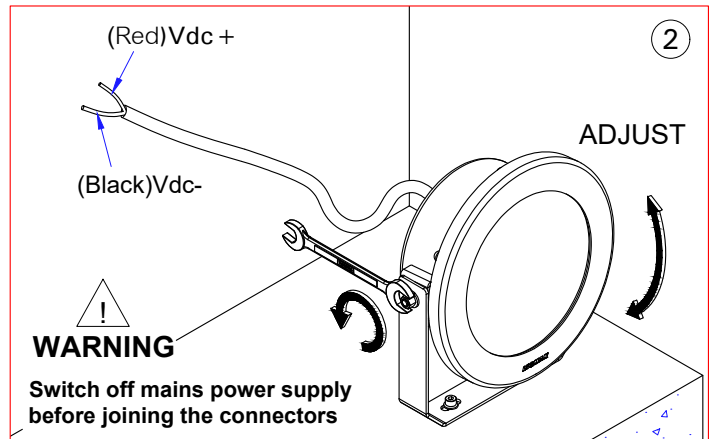
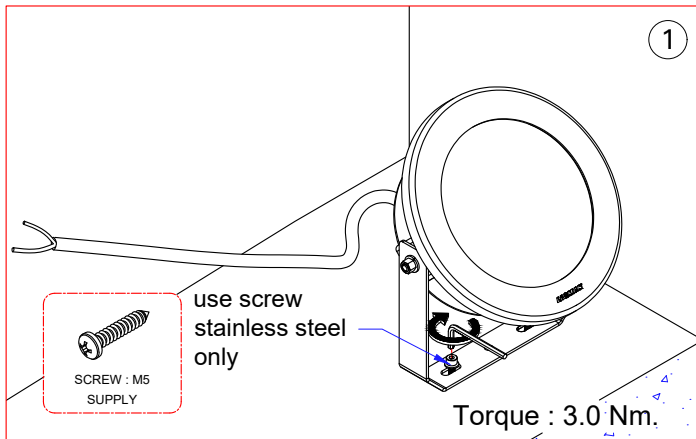
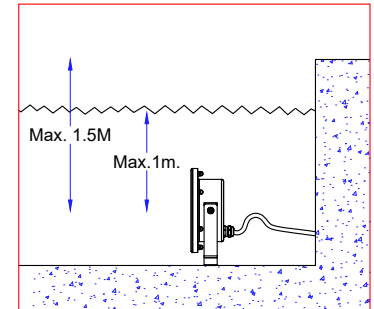

- LIGMAN standard products are supplied with the control gear 24Vdc.
The control gear for other voltages and frequencies is available upon request, please consult us for more details.
- LIGMAN luminaires are designed to conform IEC 60598 2-18 standard.
Technical amendments and modifications techniques reserved.

Ligman Lighting USA

7144 NE Progress Court, Hillsboro
Oregon, 97124, USA
Tel : 503 645 0500 | Fax : 503 645 8100

www.ligmanlightingusa.com